

ITEM	DESCRIPTION	QTY.
1	MACHINE SCREW 1/4-20 x 1/2"	4
2	KEPS NUT 1/4-20	4
3	KEPS NUT 5/16-18	24
4	MACHINE SCREW 5/16-18 x 3/4"	10
5	MACHINE SCREW 5/16-18 x 1.75"	14
6	TOP STRIP	1
7	FLAT WASHER	2
9	TELESCOPIC POST	2
10	BOTTOM STRIP	2
11	CASTER BRACKETS	4
12	4" CASTOR WHEEL THREADED STEMS	4
13	5/16" PLASTIC NUT CAP	4
14	3/4" PLASTIC SPACER (WHITE)	4
15	M8 MACHINE SCREW x 40mm (For Plasma)	4
16	M8 MACHINE SCREW x 60mm (For Plasma)	4
17	M6 MACHINE SCREW x 12mm & 16 mm	4 EA
18	M6 FLAT WASHER (For Plasma)	4
19	M8 FLAT WASHER (For Plasma)	8
20	3/4" PLASTIC SPACER (BLACK)	4
21	CORD BRACKET ASSEMBLY (A-CORD-CPK)	1

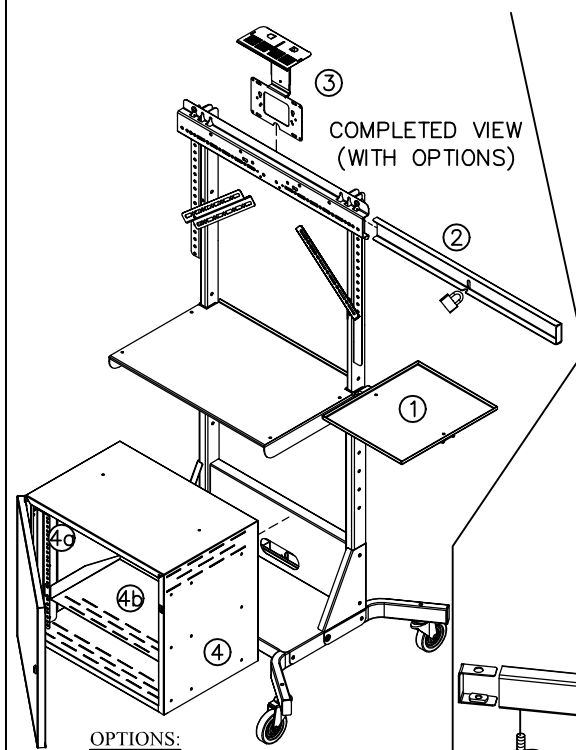

- OPTIONS:
- 1. NOTEBOOK SHELF (FOLD DOWN)
 - 2. LOCKING CHANNEL (SLIDE IN)
 - 3. CAMERA MOUNT SHELF
 - 4. LOCKING CABINET
 - 4a. LOCKING CABINET w/RACK FRAME
 - 4b. LOCKING CABINET w/RACK FRAME/SHELF

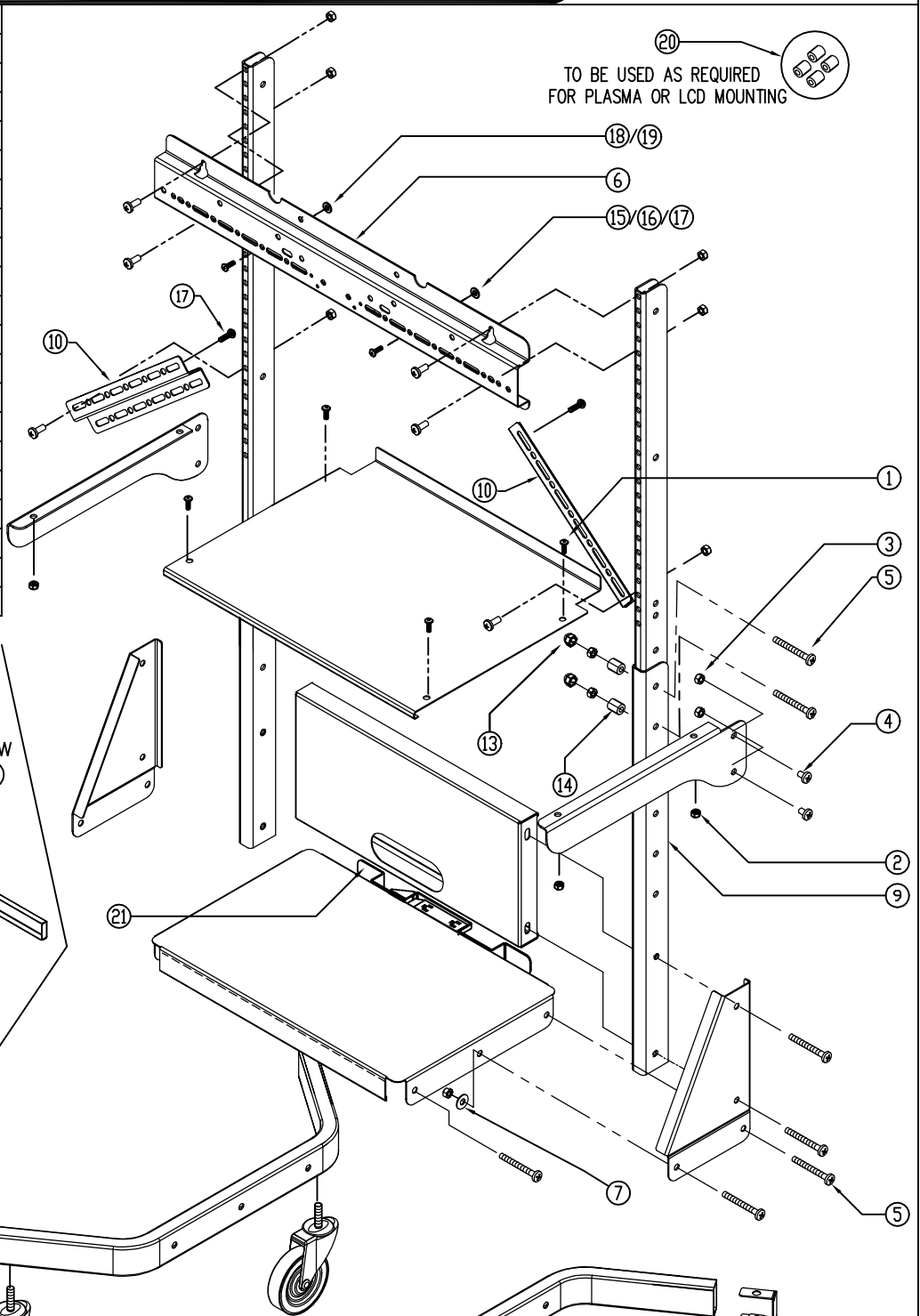
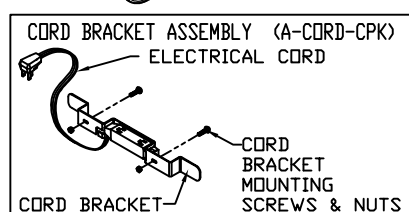
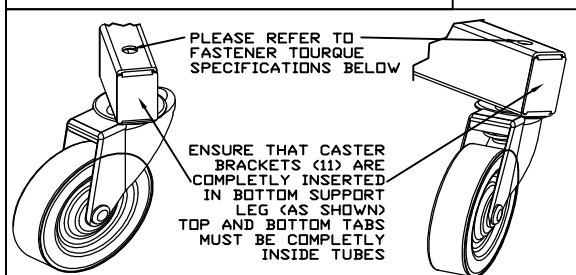

NOTE: ALL 1/4-20 FASTENERS ARE REQUIRED TO BE TORQUED TO 5-7 FT. LB OR 7-9NM
 NOTE: ALL 5/16-18 FASTENERS ARE REQUIRED TO BE TORQUED TO 10-13 FT. LB OR 14-18NM
 FOR ALL OTHER METRIC FASTENERS PLEASE REFER TO OWNERS MANUAL OF SPECIFIC PLASMA OR LCD MANUFACTURER RECOMENDATIONS
 CASTORS REQUIRED TO BE TORQUED TO